

FORM NO 1.

Courses & distances from Hemloc. down River to Maple.

- 1 S 35 W 90
- 2 S 20 W 50
- 3 S 50 W 116
- 4 S 75 W 22 to Hemloc.

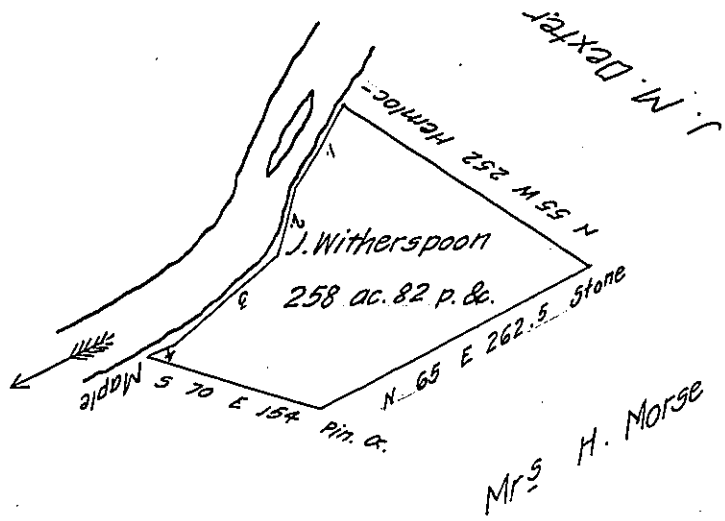

Draft of a tract of land situate in Cranberry Township Venango County East of the Alleghany River and adjoining the same about a mile below the mouth of Horse Creek. Surveyed 17 December 1832 for John Witherspoon on Improvement and Settlement.

I Wm Connely Deputy Surveyor of Venango County do Certify the above to be a true Copy of the Survey made as above stated and now remaining on the Survey Book in my Office.

Given under my hand at Franklin the 26th day of November 1840.

To the Surveyor General of Pennsylvania.

Wm Connely D.S.

IN TESTIMONY that the above is a copy of the original remaining on file in the Department of Internal Affairs of Pennsylvania, made conformably to an Act of Assembly approved the 16th day of February, 1833, I have hereunto set my Hand and caused the Seal of said Department to be affixed at Harrisburg, this tenth day of March 1908

Henry Howell
Secretary of Internal Affairs.